

WG^{co}

WHITACRE GREER

Boardwalk | 2 1/4 x 9 x 3 Permeable

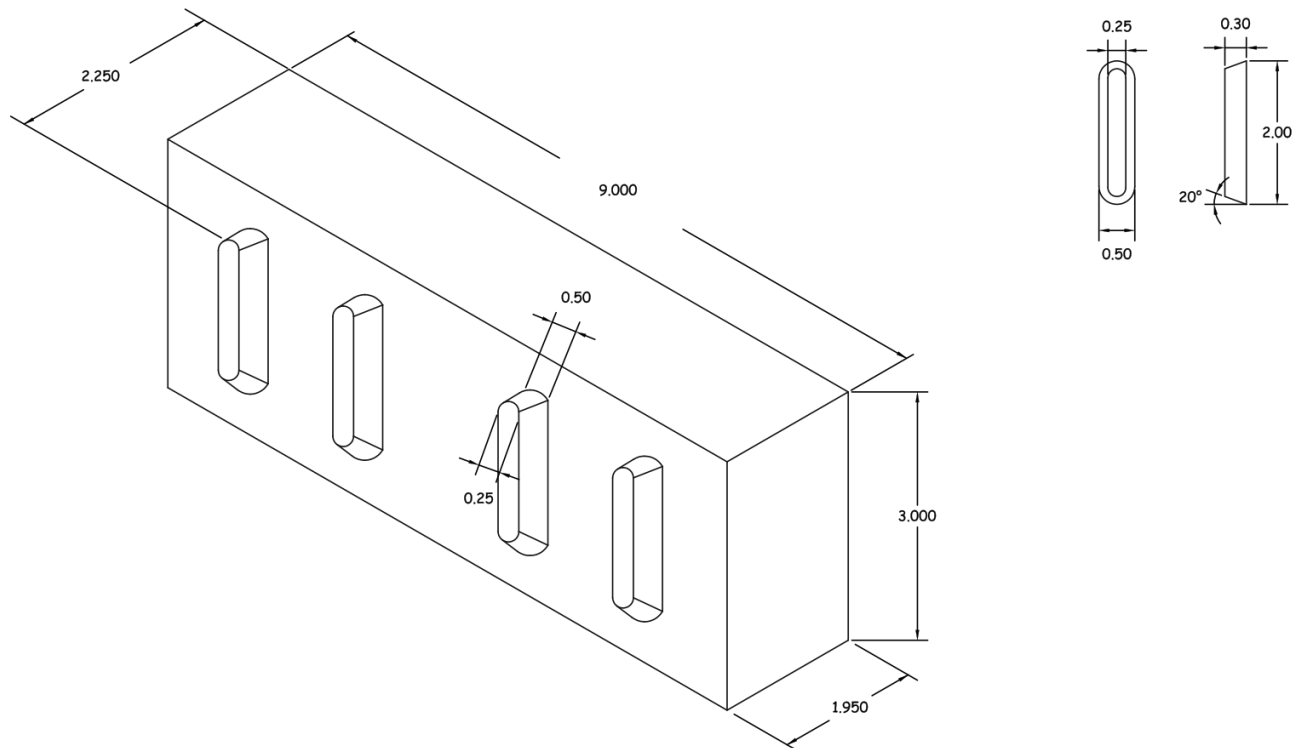

BOARDWALK WITH PERMEABLE LUGS HAS APPROXIMATELY 11% OPEN

NOTES:

1. COMPLIES WITH ASTM C1272 CLASS SX APPLICATION PS
2. AVAILABLE IN 3" THICKNESS ONLY
3. AVAILABLE IN ALL STANDARD COLORS. STANDARD COLORS MAY BE BLENDED AT THE PLANT AS PER ARCHITECT'S SPECIFICATION.
4. INSTALLTION TO BE COMPLETED IN ACCORDANCE WITH MANUFACTURER'S SPECIFICATIONS.
5. DRAWING NOT TO SCALE.
6. THIS DRAWING IS INTEDED FOR USE BY ARCHITECTS, ENGINEERS, CONTRACTORS, CONSULTANTS, AND DESIGN PROFESSIONALS FOR PLANNING PURPOSES ONLY. THIS DRAWING MAY NOT BE USED FOR CONSTRUCTION.
7. ALL INFORMATION CONTAINED HEREIN WAS CURRENT AT THE TIME OF DEVELOPMENT BUT MUST BE REVIEWED AND APPROVED BY THE PRODUCT MANUFACTURER TO BE CONSIDERED ACCURATE.
8. CONTRACTOR'S NOTE: FOR PRODUCT AND COMPANY INFORMATION VISIT: www.CADdetails.com/info AND ENTER REFERENCE NUMBER 256-123.



1400 South Mahoning Ave.
Alliance, OH 44601
P: (330) 823-1610

www.wgpaver.com
Customer Service:
cs1@wgpaver.com

Mailing:
PO Box 2960
Alliance, OH 44601